

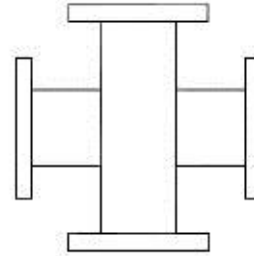

Waveguide Cross Coupler

Waveguide Cross Coupler (CW-XX Type)

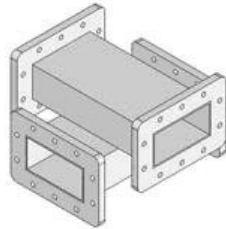

WR430 to WR90

P/N	Frequency Range (GHz)	Waveguide	Band Width	Coupling (dB)	Directivity (dB) Min.	VSWR Mainline	VSWR Second line	Flange	Material
430CW-XX	1.70-2.60	WR430	10-20%	20/30 /40/50	18	1.15	1.25	FDP22/ FDM22	Al
340CW-XX	2.20-3.30	WR340	10-20%	20/30 /40/50	18	1.15	1.25	FDP26/ FDM26	Al
284CW-XX	2.60-3.95	WR284	10-20%	20/30 /40/50	18	1.15	1.25	FDP32/ FDM32	Al/Cu
229CW-XX	3.30-4.90	WR229	10-20%	20/30 /40/50	18	1.15	1.25	FDP40/ FDM40	Al/Cu
187CW-XX	3.95-5.85	WR187	10-20%	20/30 /40/50	18	1.15	1.25	FDP48/ FDM48	Al/Cu
159CW-XX	4.90-7.05	WR159	10-20%	20/30 /40/50	18	1.15	1.25	FDP58/ FDM58	Al/Cu
137CW-XX	5.85-8.20	WR137	10-20%	20/30 /40/50	18	1.15	1.25	FDP70/ FDM70	Al/Cu
112CW-XX	7.05-10.0	WR112	10-20%	20/30 /40/50	18	1.15	1.25	FBP84/ FBM84/ FBE84	Al/Cu
90CW-XX	8.20-12.4	WR90	10-20%	20/30 /40/50	18	1.15	1.25	FBP100/ FBM100/ FBE100	Al/Cu



Waveguide Cross Coupler

Waveguide Cross Coupler (CW -XX Type)

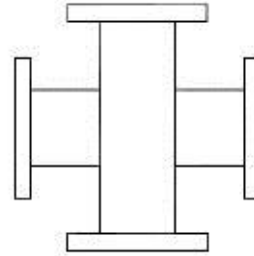
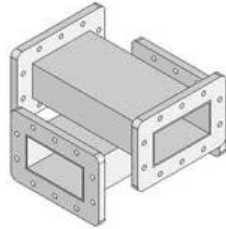

WR75 to WR28

P/N	Frequency Range (GHz)	Waveguide	Band Width	Coupling (dB)	Directivity (dB) Min.	VSWR Mainline	VSWR Second line	Flange	Material
75CW-XX	10.0-15.0	WR75	10-20%	20/30 /40/50	18	1.15	1.25	FBP120/ FBM120/ FBE120	Al/Cu
62CW-XX	12.4-18.0	WR62	10-20%	20/30 /40/50	18	1.15	1.25	FBP140/ FBM140/ FBE140	Al/Cu
51CW-XX	15.0-22.0	WR51	10-20%	20/30 /40/50	18	1.15	1.25	FBP180/ FBM180/ FBE180	Cu
42CW-XX	18.0-26.5	WR42	10-20%	20/30 /40/50	18	1.15	1.25	FBP220/ FBM220/ FBE220	Cu
34CW-XX	22.0-33.0	WR34	10-20%	20/30 /40/50	18	1.15	1.25	FBP260/ FBM260/ FBE260	Cu
28CW-XX	26.5-40.0	WR28	10-20%	20/30 /40/50	18	1.20	1.25	FBP320/ FBM320/ FBE320	Cu



Waveguide Cross Coupler

Waveguide Cross Coupler (CWL -XX Type)

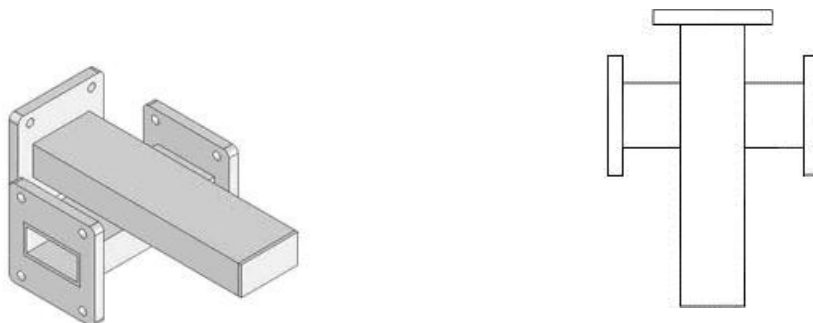

WR430 to WR90

P/N	Frequency Range (GHz)	Waveguide	Band Width	Coupling (dB)	Directivity (dB) Min.	VSWR Mainline	VSWR Second line	Flange	Material
430CWL-XX	1.70-2.60	WR430	10-20%	20/30 /40/50	18	1.15	1.25	FDP22/ FDM22	Al
340CWL-XX	2.20-3.30	WR340	10-20%	20/30 /40/50	18	1.15	1.25	FDP26/ FDM26	Al
284CWL-XX	2.60-3.95	WR284	10-20%	20/30 /40/50	18	1.15	1.25	FDP32/ FDM32	Al/Cu
229CWL-XX	3.30-4.90	WR229	10-20%	20/30 /40/50	18	1.15	1.25	FDP40/ FDM40	Al/Cu
187CWL-XX	3.95-5.85	WR187	10-20%	20/30 /40/50	18	1.15	1.25	FDP48/ FDM48	Al/Cu
159CWL-XX	4.90-7.05	WR159	10-20%	20/30 /40/50	18	1.15	1.25	FDP58/ FDM58	Al/Cu
137CWL-XX	5.85-8.20	WR137	10-20%	20/30 /40/50	18	1.15	1.25	FDP70/ FDM70	Al/Cu
112CWL-XX	7.05-10.0	WR112	10-20%	20/30 /40/50	18	1.15	1.25	FBP84/ FBM84/ FBE84	Al/Cu
90CWL-XX	8.20-12.4	WR90	10-20%	20/30 /40/50	18	1.15	1.25	FBP100/ FBM100/ FBE100	Al/Cu



Waveguide Cross Coupler

Waveguide Cross Coupler (CWL -XX Type)

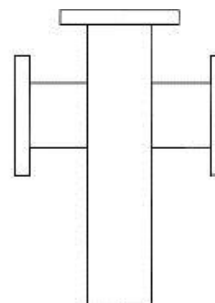
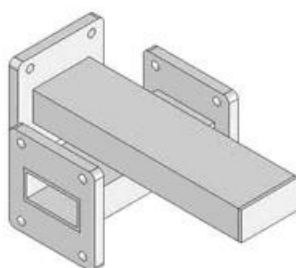

WR75 to WR28

P/N	Frequency Range (GHz)	Waveguide	Band Width	Coupling (dB)	Directivity (dB) Min.	VSWR Mainline	VSWR Second line	Flange	Material
75CWL-XX	10.0-15.0	WR75	10-20%	20/30 /40/50	18	1.15	1.25	FBP120/ FBM120/ FBE120	Al/Cu
62CWL-XX	12.4-18.0	WR62	10-20%	20/30 /40/50	18	1.15	1.25	FBP140/ FBM140/ FBE140	Al/Cu
51CWL-XX	15.0-22.0	WR51	10-20%	20/30 /40/50	18	1.15	1.25	FBP180/ FBM180/ FBE180	Cu
42CWL-XX	18.0-26.5	WR42	10-20%	20/30 /40/50	18	1.15	1.25	FBP220/ FBM220/ FBE220	Cu
34CWL-XX	22.0-33.0	WR34	10-20%	20/30 /40/50	18	1.15	1.25	FBP260/ FBM260/ FBE260	Cu
28CWL-XX	26.5-40.0	WR28	10-20%	20/30 /40/50	18	1.20	1.25	FBP320/ FBM320/ FBE320	Cu



Waveguide Cross Coupler

Waveguide Cross Coupler (CWL+CN-XX Type)



WR430 to WR90

P/N	Frequency Range (GHz)	Waveguide	Band Width	Coupling (dB)	Directivity (dB) Min.	VSWR Mainline	VSWR Second line	Flange	Material
430CWL+CN - XX	1.70-2.60	WR430	10-20%	20/30 /40/50	18	1.15	1.25	FDP22/ FDM22	Al
340CWL+CN - XX	2.20-3.30	WR340	10-20%	20/30 /40/50	18	1.15	1.25	FDP26/ FDM26	Al
284CWL+CN - XX	2.60-3.95	WR284	10-20%	20/30 /40/50	18	1.15	1.25	FDP32/ FDM32	Al/Cu
229CWL+CN - XX	3.30-4.90	WR229	10-20%	20/30 /40/50	18	1.15	1.25	FDP40/ FDM40	Al/Cu
187CWL+CN - XX	3.95-5.85	WR187	10-20%	20/30 /40/50	18	1.15	1.25	FDP48/ FDM48	Al/Cu
159CWL+CN - XX	4.90-7.05	WR159	10-20%	20/30 /40/50	18	1.15	1.25	FDP58/ FDM58	Al/Cu
137CWL+CN - XX	5.85-8.20	WR137	10-20%	20/30 /40/50	18	1.15	1.25	FDP70/ FDM70	Al/Cu
112CWL+CN - XX	7.05-10.0	WR112	10-20%	20/30 /40/50	18	1.15	1.25	FBP84/ FBM84/ FBE84	Al/Cu
90CWL+CN - XX	8.20-12.4	WR90	10-20%	20/30 /40/50	18	1.15	1.25	FBP100/ FBM100/ FBE100	Al/Cu



Waveguide Cross Coupler

Waveguide Cross Coupler (CWL -XX Type)



WR75 to WR28

P/N	Frequency Range (GHz)	Waveguide	Band Width	Coupling (dB)	Directivity (dB) Min.	VSWR Mainline	VSWR Second line	Flange	Material
75CWL+CS - XX	10.0-15.0	WR75	10-20%	20/30 /40/50	18	1.15	1.25	FBP120/ FBM120/ FBE120	Al/Cu
62CWL+CS - XX	12.4-18.0	WR62	10-20%	20/30 /40/50	18	1.15	1.25	FBP140/ FBM140/ FBE140	Al/Cu
51CWL+CS - XX	15.0-22.0	WR51	10-20%	20/30 /40/50	18	1.15	1.25	FBP180/ FBM180/ FBE180	Cu
42CWL+CS - XX	18.0-26.5	WR42	10-20%	20/30 /40/50	18	1.15	1.25	FBP220/ FBM220/ FBE220	Cu
34CWL+CS - XX	22.0-33.0	WR34	10-20%	20/30 /40/50	18	1.15	1.25	FBP260/ FBM260/ FBE260	Cu
28CWL+CK - XX	26.5-40.0	WR28	10-20%	20/30 /40/50	18	1.20	1.25	FBP320/ FBM320/ FBE320	Cu

Specification may change without notice