

## Technical Specification

Frequency Range(GHz)	0.5-18
Insertion Loss(dB)	3.5
Isolation(dB)	60
VSWR	2.0
Switching Speed(ns)	50 max
Power Handling(W)	1 CW max
Operating Temperature(°C)	-55 ~ +85
Storage Temperature(°C)	-65 ~ +125

## Outline Drawing (Size: mm)

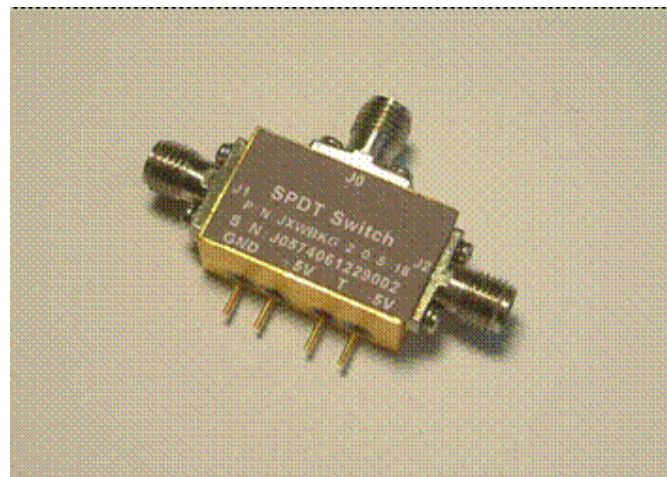
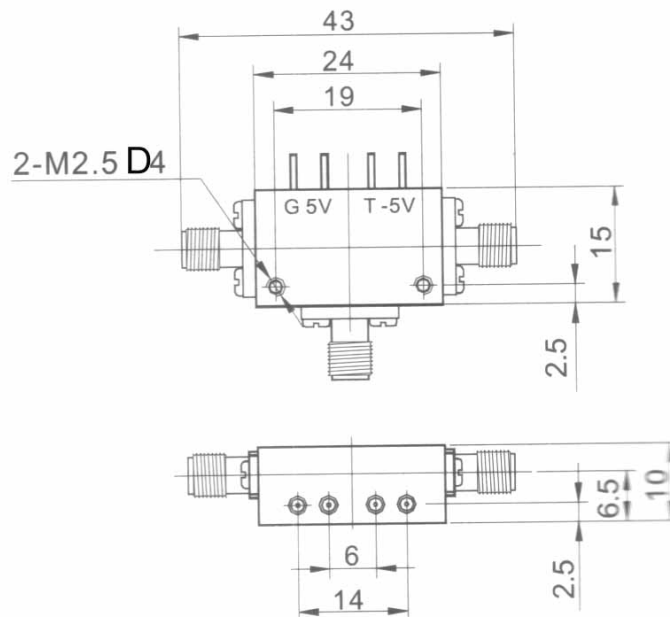

188 Technology Dr. Unit H, Irvine, CA 92618

Tel: 949-453-9888, FAX: 949-453-8889, Email: Sales@aacix.com

## Test Instruments

- 🕒 CC142
- 🕒 E8362A

## Test Results

### 1. Insertion Loss

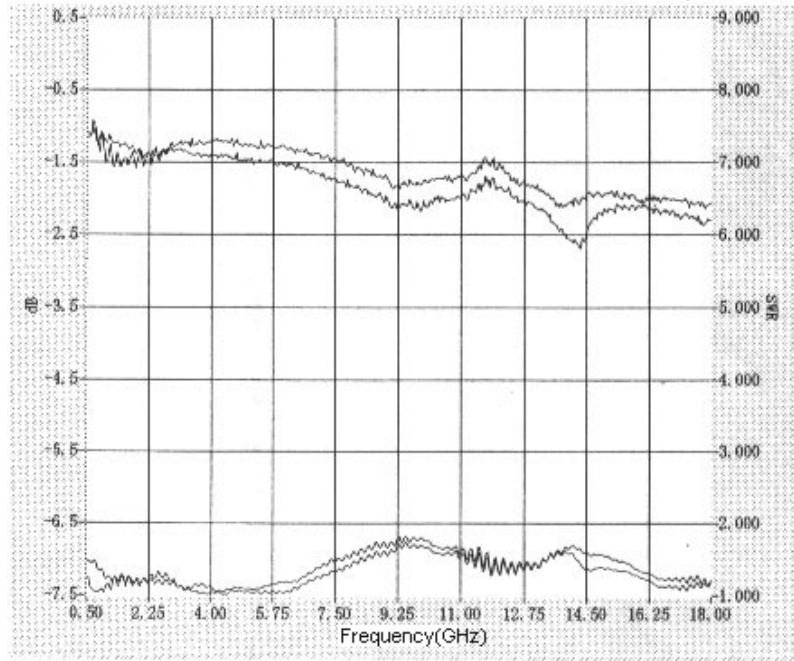

### 2. Isolation

